

# TYPAR® ALL-TEMPERATURE FLASHING SELF-ADHERING WINDOW FLASHING

## TYPAR ALL-TEMPERATURE FLASHING—TYPICAL INSTALLATION

### STEP 1

Make diagonal cuts on weather-resistant barrier. Gently lift and tape in place. Cut flashing long enough to extend beyond opening by a minimum of the width of flashing you are using. Attach flashing along bottom of rough opening.

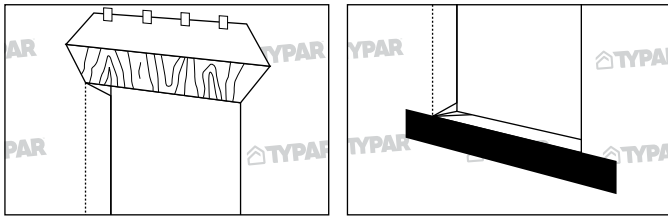

### STEP 2

Before installing window, apply a continuous bead of sealant to interior window's mounting flange. Install window per manufacturer's instructions. Using release paper as a guide, slowly peel back release paper and press TYPAR All-Temperature Flashing in place.

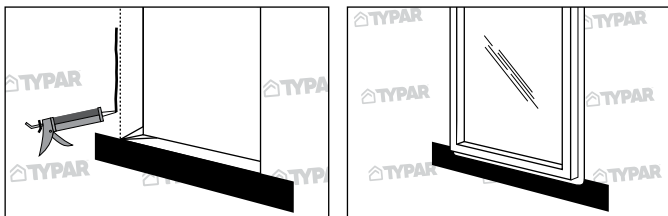

### STEP 3

Embed jamb flashing into the sealant and fasten in place. Run jamb flashing beyond sill flashing and above where sill flashing will intersect. Using release paper to help guide flashing, peel release paper off as you press flashing in place. Insure flashing covers all nails and mounting slots on window's mounting flange.

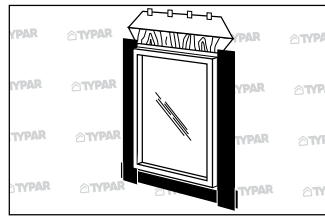

### STEP 4

Cut head flashing so it will extend beyond jamb flashing. Finally, lay weather-resistant barrier over head flashing. Apply sheathing tape over both diagonal cuts.

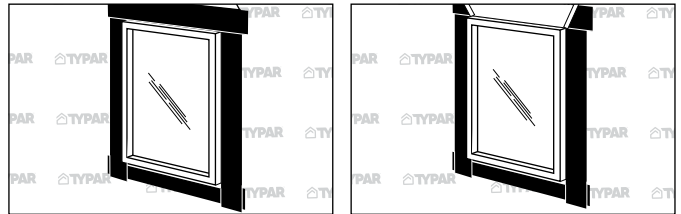

**NOTE:** All installation procedures and techniques must comply with local code requirements and latest version of ASTM 2112.

Installation methods approved by the American Architectural Manufacturers Association (AAMA) are acceptable for TYPAR® products and TYPAR® Weather Protection System Limited Warranty.

**WARNING:** Flashing will not address the water intrusion which may occur through the window itself.

For more information, visit [TYPAR.com](http://TYPAR.com).

© 2017, Berry Plastics Corporation.  
TYPAR® is a registered trademark of Berry Plastics Corporation or its affiliate.  
Please visit [TYPAR.com](http://TYPAR.com) for installation instructions and warranty information.  
Building Wraps | Flashings | Construction Tape | Fasteners



3385

